

C 4 - 66

Richard Adlum.

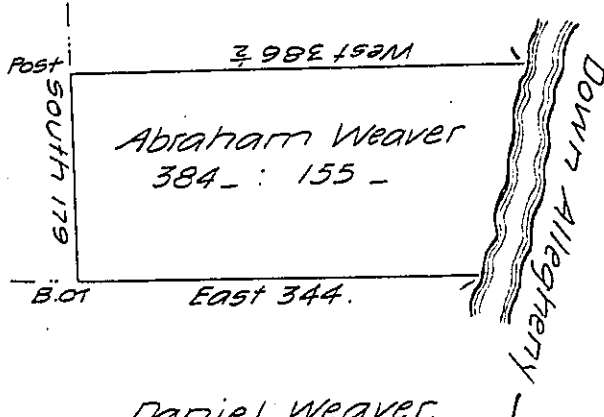

Courses on the River

- N. 15° E. 60.
- N. 11. E. 87.
- N. 25 E 8.
- N. 14. E 29
- 164

Daniel Weaver.

Og-137

Surveyed on the 22nd day of June 1795 the above described Tract of Land, in District No. 6, in pursuance of a Warrant to Abraham Weaver, dated 20th Decr. 1793, containing Three Hundred Eighty four acres & 155 perches and allowance of six per cent.

Saml. Nicholson D.S.

To Daniel Brodhead Esqr.

Surveyor General.

IN TESTIMONY that the above is a copy of the original remaining on file in the Department of Internal Affairs of Pennsylvania, made conformably to an Act of Assembly approved the 16th day of February 1833, I have hereunto set my hand and caused the Seal of said Department to be affixed at Harrisburg, this twenty-seventh day of June 1907

Henry Houck
 Secretary of Internal Affairs.